

2



2



1

Introducing Your Dream Lakeside Retreat!

Welcome to your very own oasis in the heart of Mermaid Waters! This stunning 2-bedroom, 2-bathroom residence boasts an unparalleled view of the picturesque Lake Intrepid that will leave you breathless. With 121 sqm of pure luxury, this is a home that redefines modern living.

Step inside and be greeted by an abundance of natural light, flowing seamlessly through the open-plan layout with ducted air conditioning. The spacious living area provides a canvas for your imagination, ready to be transformed into your ideal sanctuary.

Every detail of this residence exudes luxury and sophistication. High-end fittings and fixtures adorn every corner, showcasing a level of craftsmanship that sets this property apart.

The heart of this home is a chef's dream - a sprawling kitchen with a vast bench, providing ample space for culinary creations. Storage is abundant, ensuring a clutter-free environment.

Retreat to your spacious bedrooms which can fit a kingsize bed and two bedside tables, where comfort meets tranquillity. Wake up to the gentle sparkle of sunlight dancing on the la

Price: \$965,000

Sherie Jafari

0493 435 713

LEVELS 3-11

UNITS 1301, 1401, 1501, 1601, 1701,
1801, 1901, 11001, 11101

INTERNAL FLOOR AREA	110m ²
BALCONY AREA	11m ²
TOTAL AREA	121m ²

01 ENTRY 02 LIVING 03 DINING
04 KITCHEN 05 BATHROOM 06 LAUNDRY
07 LINEN 08 BEDROOM 09 WALK-IN ROBE
10 ENSUITE 11 STUDY 12 BALCONY

0m 5m

EAST VILLAGE KEY PLAN

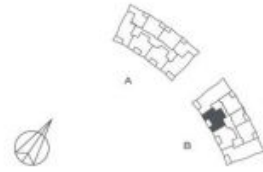

Inclusive floor plan and artist impression only. Refer to the floor plans contained in the contract of sale for the actual floor plan as variations may apply. All floor areas measured to the centre of external walls and centre line of party walls. All external areas (patio and balcony) are included in the area calculation. External architectural features shown are indicative only. All reasonable care has been taken in the preparation of these floor plans. To the best of our knowledge, no relevant information has been omitted. However, Sunland Group Limited and its appointed agents declare all liability should any information or matter contained herein differ from the contract of sale or the actual constructed development. Images are illustrative only and all information is correct at the time of printing. © Sunland Group Limited. All rights reserved.

